

08 9725 6852

HansenAutomotiveCentre@gmail.com



Use this guide to assist in the installation of the Fuel Manager Pre-Filter Kit. This kit will only fit the stated vehicle. Although these kits are aimed at DIY enthusiasts, we suggest the inexperienced organise a mechanic to carry out the installation.

before starting : please read this important information

- Ensure the engine bay is clean and free from contaminants.
- The Fuel Manager unit has arrows which indicate flow located under the ports.
- Install all fittings & plugs into the filter assembly using a suitable thread paste such as Permalock Thread Sealant.

**** Kit contents may change due to reinement or parts availability.**

FM603DPK Kit Contains:

- 1x Fuel Manager 100 30 Micron Filter Assy
- 1x Spare 30 Micron Filter
- 1x Vehicle Specific Bracket
- 1x Hand Primer Kit
- 4x Fuel Line Rubber 10mm / 4x 6mm Washer
- 3x Zinc Bolts 8x25mm / 3x Hose Clamp 10mm
- 2x Push on Straight 10mm / 2x Bolts & Nuts, 4x Washers
- 2x NPT Plug 1/4" DP733-04 / 2x NPT Straight 1/4" 12mm
- 1x Nyloc Nut M8 / 1x Nyloc Nut 6mm / 1x Zinc 8x17mm
- 1x 90° Barb 9.89x8mm / 1x End Barb Str 9.89x10mm
- 1x Spring Washer / 1x Washer 6mmx25mm
- 1x 1.25x40mm Z PS SCR M8

Installation Overview: (Full instructions with images on page 2).

The Fuel Manager Kit is fitted in the area behind the passenger side headlight (see image above right).

The Bracket is secured in place by 3x Bolts:

2x 6mm bolts on the forward side (through holes previously used by plastic fasteners to hold wiring (Img:1).

1x Bolt on the rear side through the inner guard (Img:2).

This rear hole has two variations:

- May have a thread to take a 6mm bolt or
- Has no thread but has a hexagon shaped hole (requiring an 8mm bolt with a nut).

The Amarok fuel supply system cannot be primed or bled in the usual manner. Volkswagen dealers use a scan tool to activate the tank mounted electric supply pump when changing a filter. Consequently you need to pre fill the Fuel Manager filter at the time of installation. For this you will need about 400ml of diesel in a clean container or bottle.



FUEL MANAGER®
FITTING INSTRUCTIONS

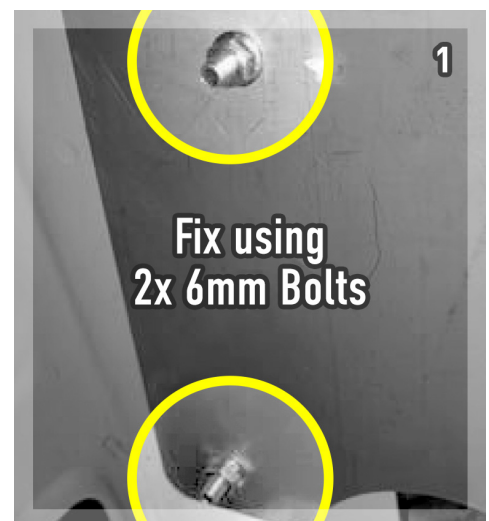

08 9725 6852

HansenAutomotiveCentre@gmail.com

Hansen Automotive
Affordable Rates • Quality Work • Reliable
www.HansenAutomotiveCentre.com



Fitting Instructions:

1. Temporarily position the bracket in place so you can see where it is & how it is secured. Now remove the bracket, with side cutters or a utility knife cut the tip from the 2 plastic loom securing fasteners. Push the 2 fasteners out of their holes. These 2 holes are now used to secure the bracket in place (Img.1).
2. Re-position the bracket and insert the appropriate sized bolt in the rear mounting point (Img.2). Then install the two forward bolts, washers and nuts. Tighten all 3 mounting bolts.
Insert the clip-to-hole Zip-Tie into the hole provided in the bracket from the back side of the bracket, then secure the wiring loom.
3. Take the Fuel Manager filter and temporarily position it where it will mount to the bracket. Install the two blanking plugs into the two forward facing holes at position (Img.1), and the two straight barb fittings into the holes that will face rearward in position (Img.3). Use the thread sealant provided on the threads.
Take note of the arrows near the threaded holes which indicate direction of low IN </OUT>.
4. Mount the Fuel Manager filter to the bracket using the 10mm bolts & nuts.
5. Cut the fuel hose into two pieces: 1x 2mtr / 1x 1.6mtr.
6. Fit the female quick-connect fitting provided to the 1.6mtr length, secure with a hose clamp, at the opposite end of the hose to the Fuel Manager "IN" barb fitting.
7. Fit the male quick-connect fitting to the 2mtr long hose, secure with a clamp and at the opposite end to the Fuel Manager "OUT" barb fitting. Secure with a clamp.
8. Route both hoses from the Fuel Manager towards the back of the engine bay, down the firewall, following the existing steel pipes, toward the VW fuel filter located under the passenger side foot well. The pipes are to be connected to quick-connect fittings (Img.4).
Take care to route the hoses so they are not kinked.
9. Double check your connections regarding flow are correct before securing with Zip-ties to tidy the hoses.
10. The filter must now be filled with diesel. Remove the filter cartridge from the Fuel Manager-head by unscrewing the large retaining nut. Manually fill the cartridge with clean diesel before re-assembly.
- IMPORTANT!! Take extreme care with cleanliness !**
11. Start the engine. Typically takes 5 seconds of cranking to start.
12. Once installed, run the engine and check for any leaks.



FUEL MANAGER®
FITTING INSTRUCTIONS

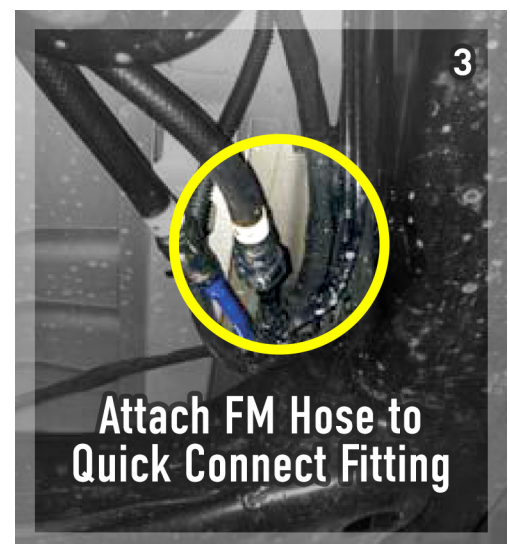
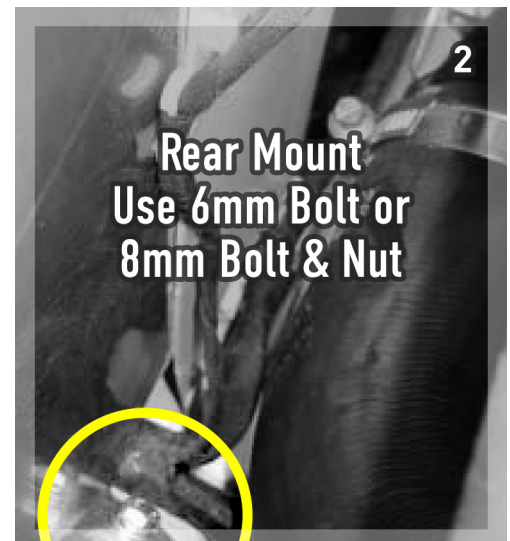

Hansen Automotive Centre Unit 1 - 10 Halifax Dr, Davenport WA 6230 | Mon - Fri: 7.45am - 5.30pm

www.HansenAutomotiveCentre.com | 08 9725 6852 | hansenautomotivecentre@gmail.com